

Sources for History of FAUNA & FLORA

Mike Derbyshire



ORCHARD

LGGS

FAUNA

FLORA

OS 25 in 1893

Lancaster

Aldcliffe

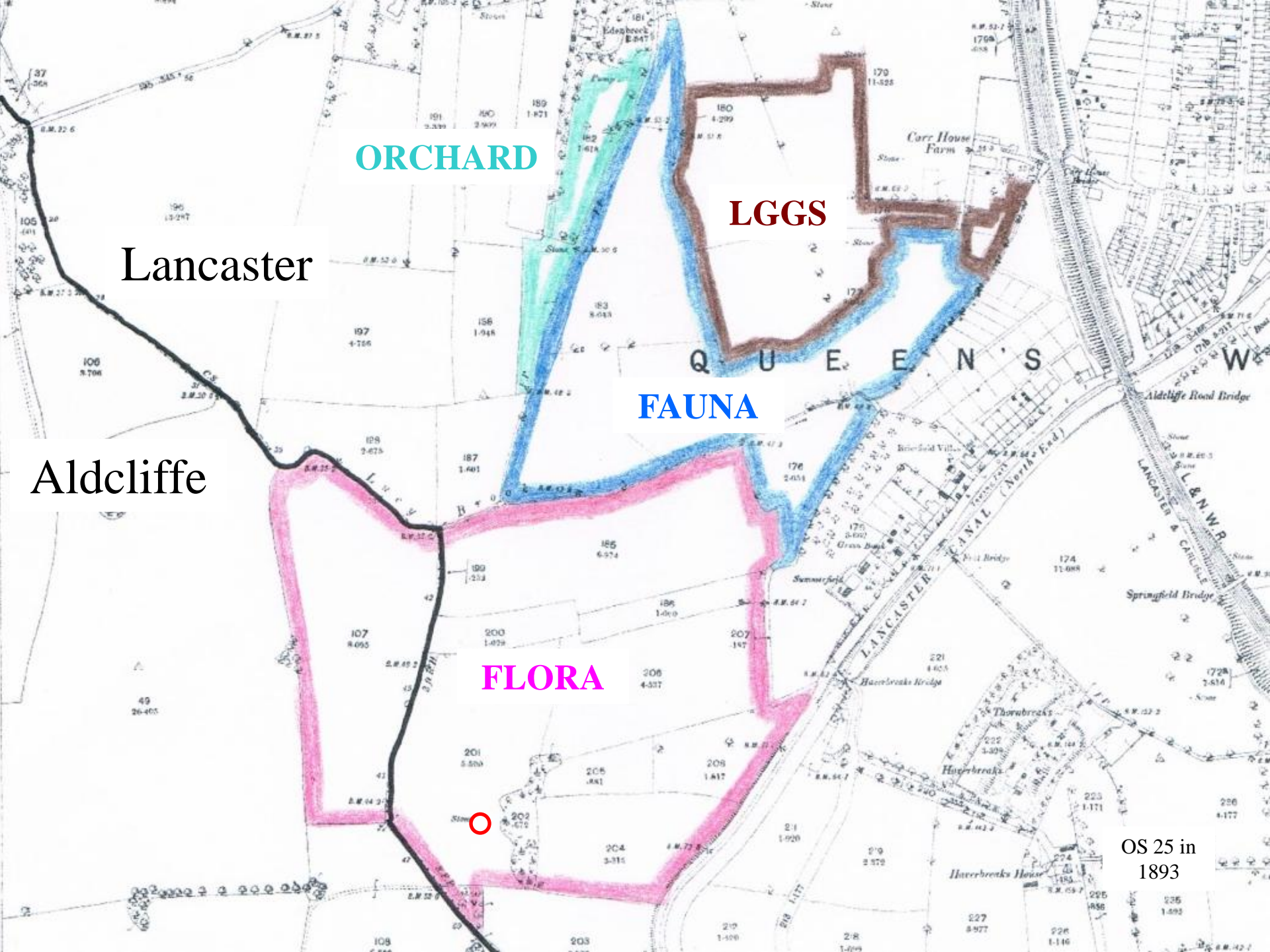

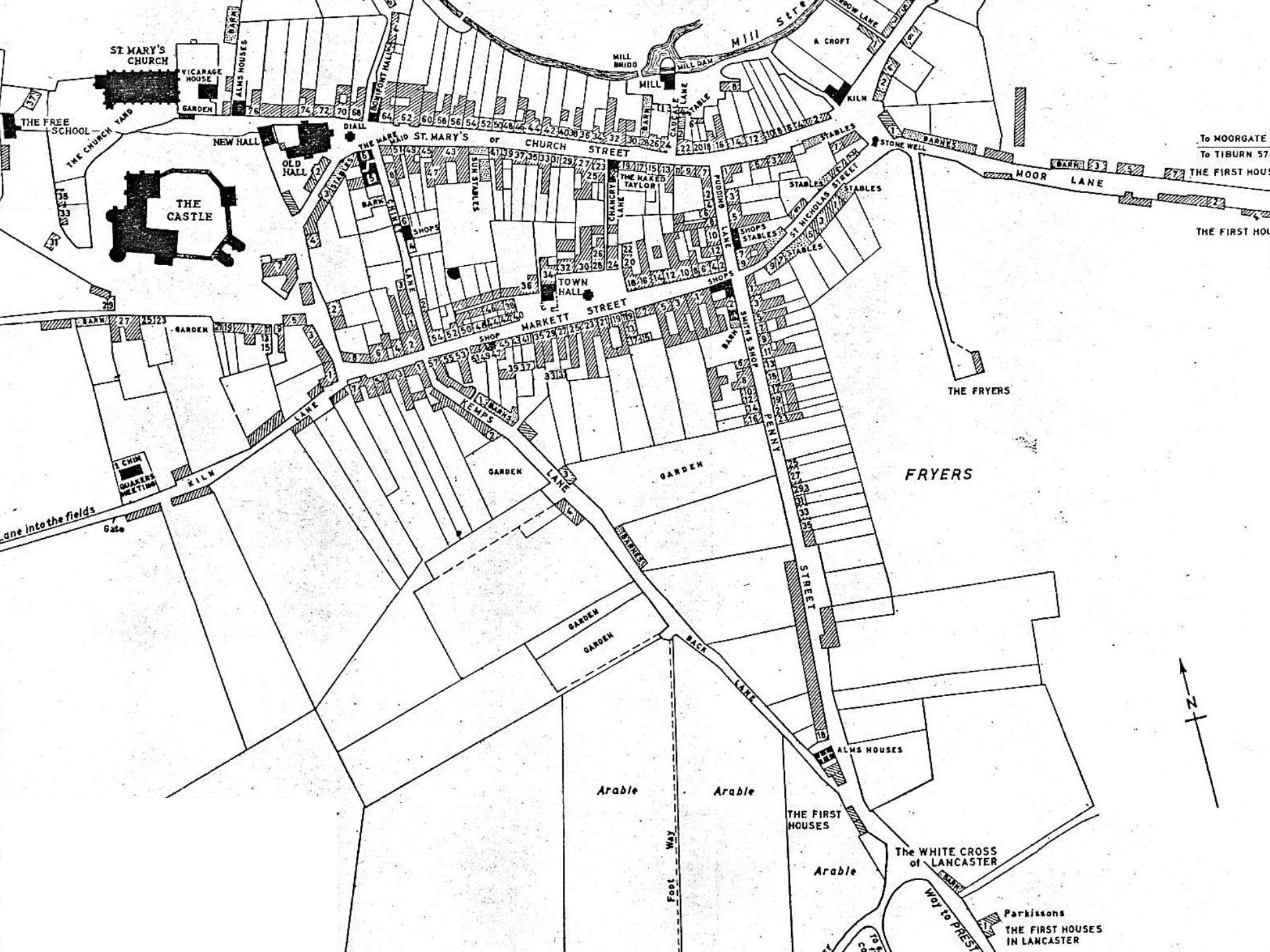

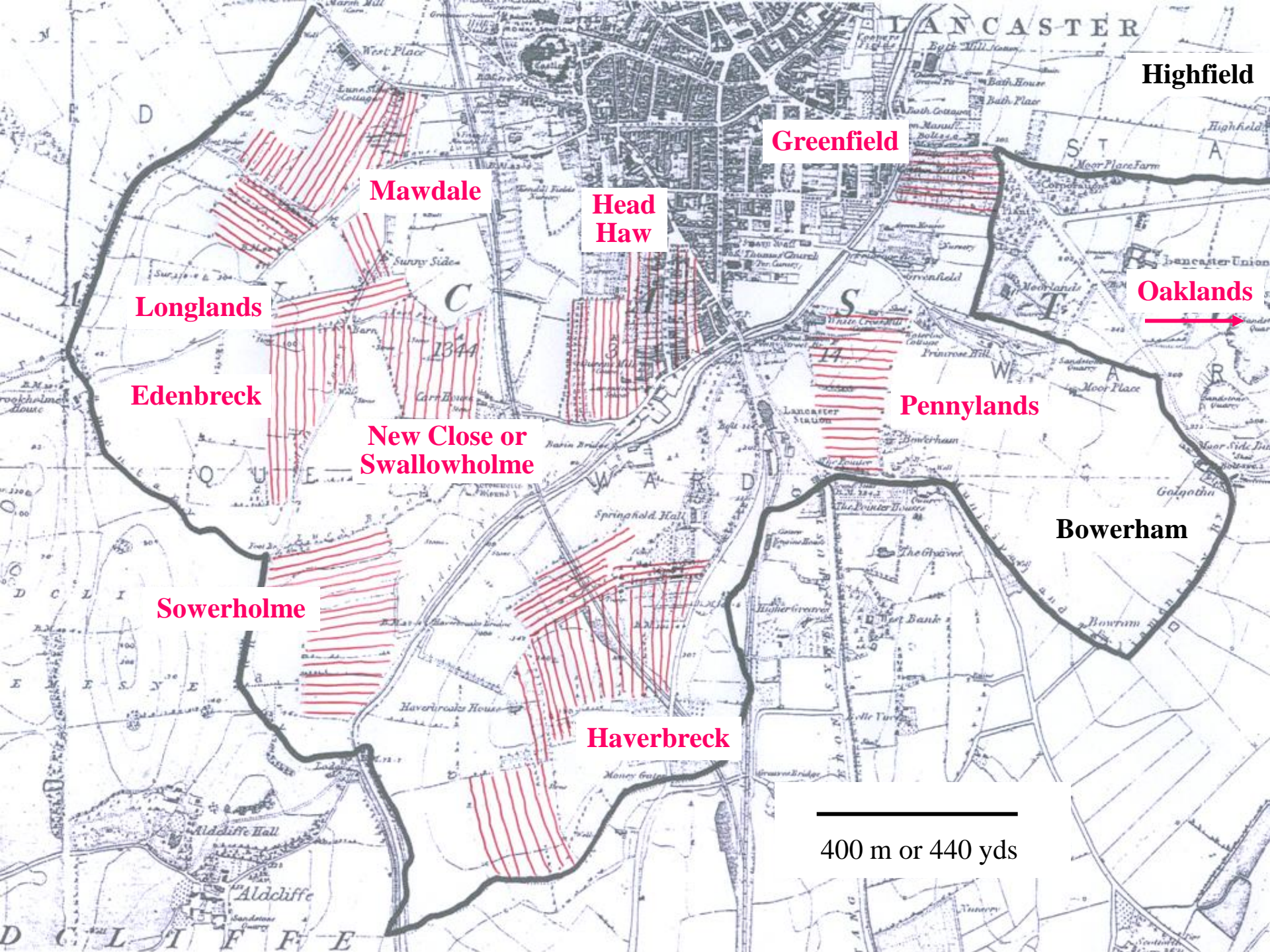

Highfield

Greenfield

Mawdale

Head
Haw

Longlands

Oaklands

Edenbreck

New Close or
Swallowholme

Pennylands

Sowerholme

Bowerham

Haverbreck

400 m or 440 yds







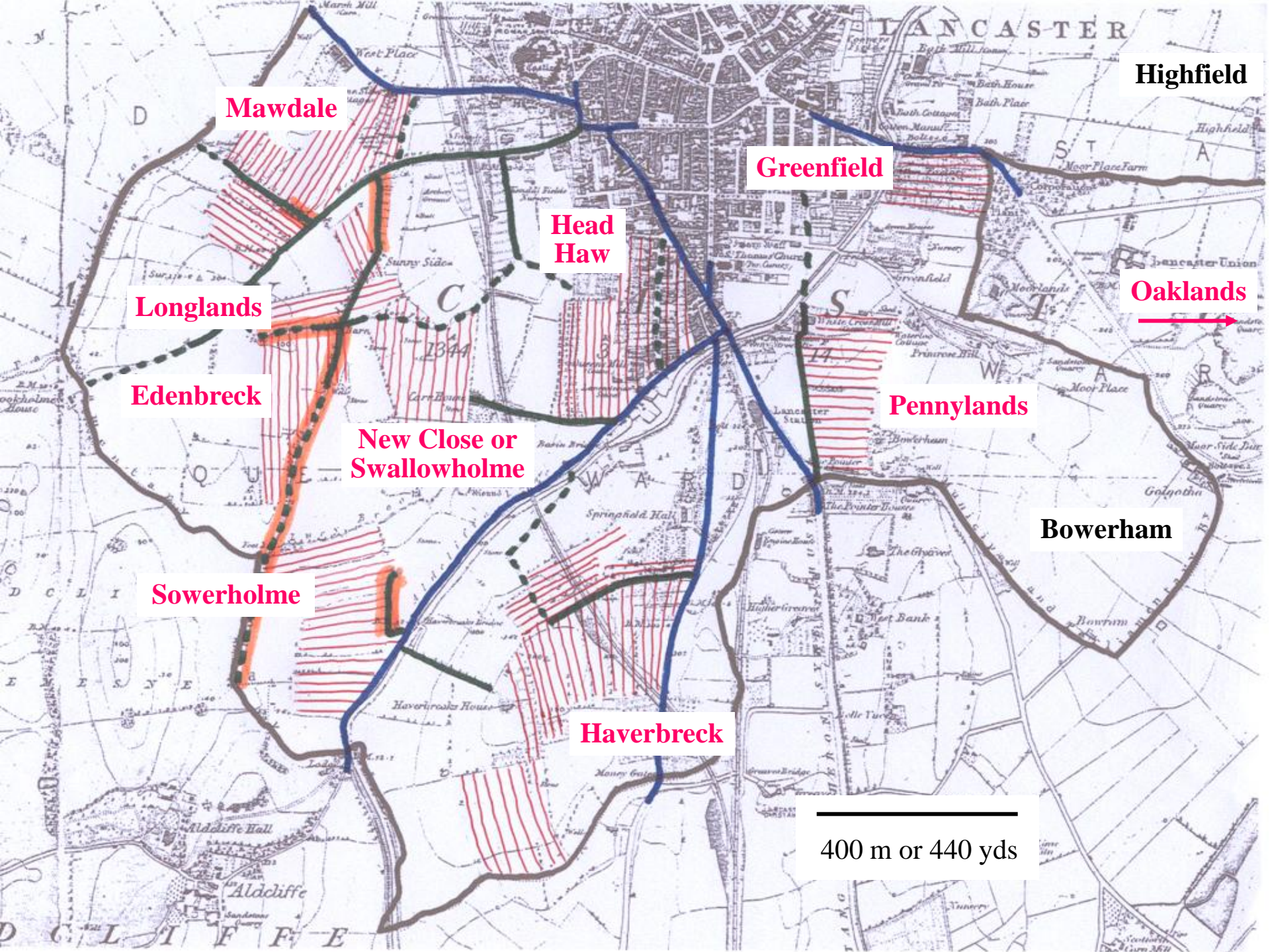

Mawdale

Greenfield

**Head
Haw**

Longlands

Oaklands

Edenbreck

**New Close or
Swallowholme**

Pennylands

Sowerholme

Bowerham

Haverbreck

400 m or 440 yds

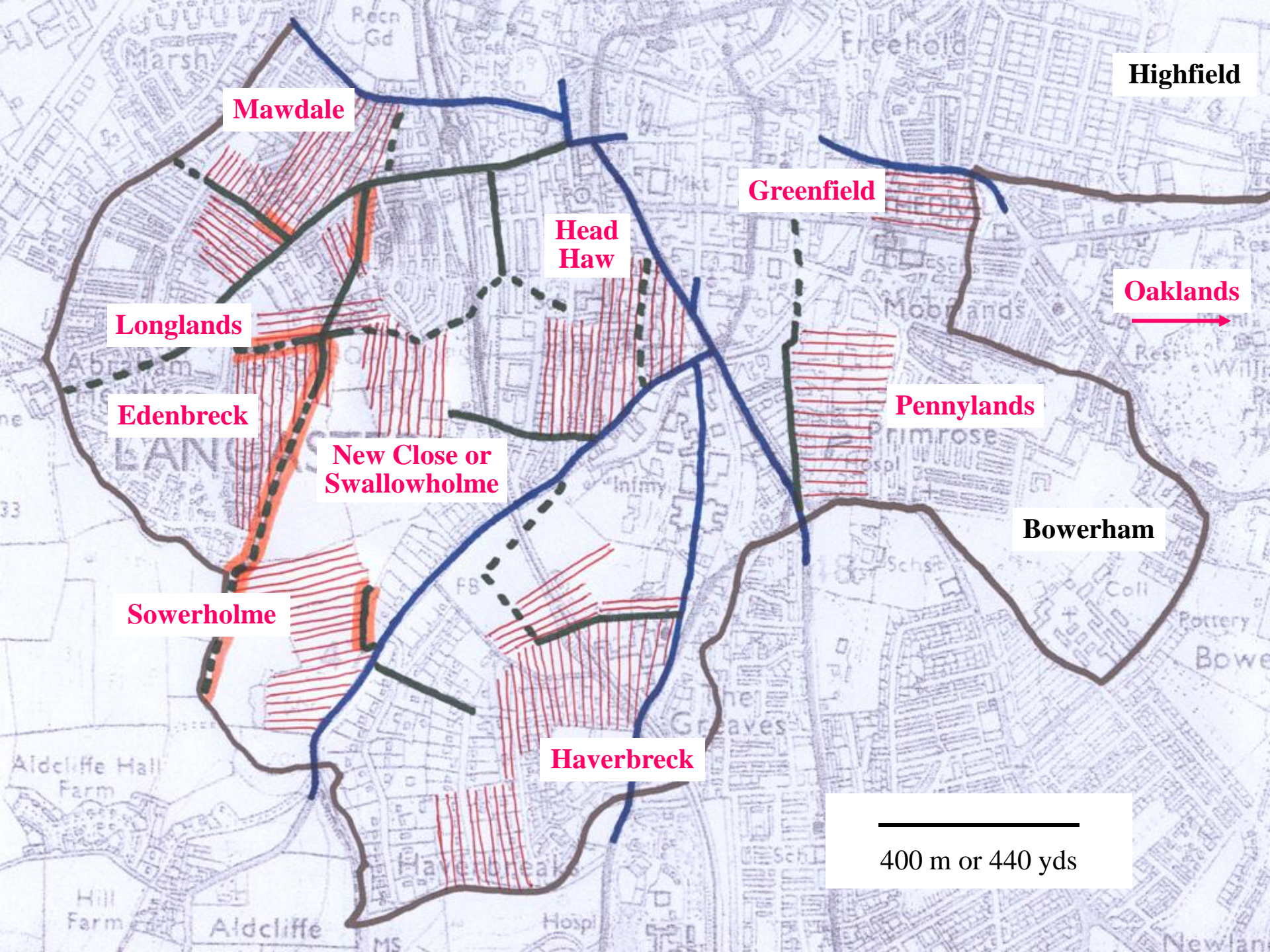

Highfield

Mawdale

Greenfield

Head Haw

Oaklands

Longlands

Edenbreck

New Close or Swallowholme

Pennylands

Bowerham

Sowerholme

Haverbreck

400 m or 440 yds

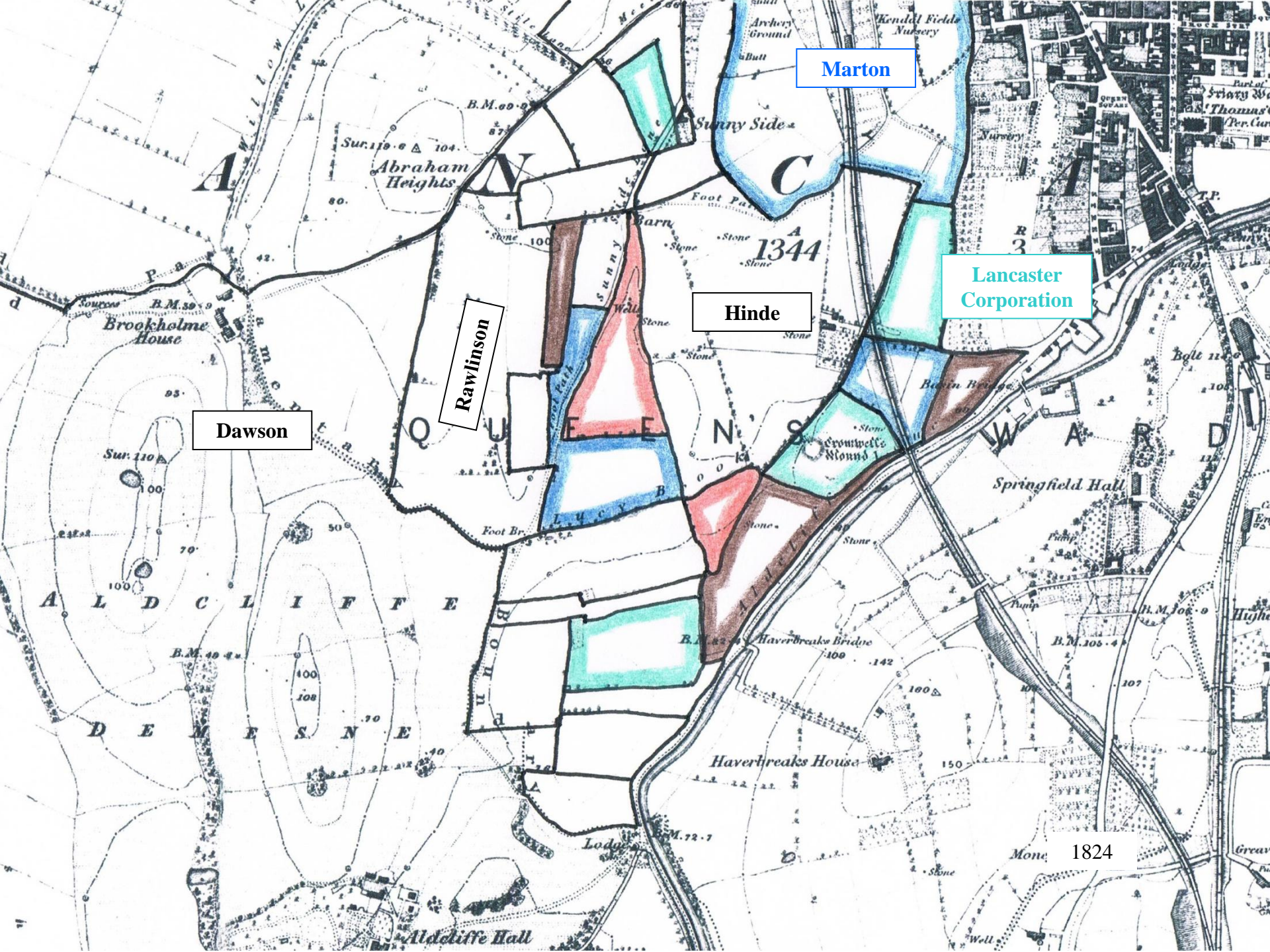

Marton

Lancaster Corporation

Hinde

Rawlinson

Dawson

1824

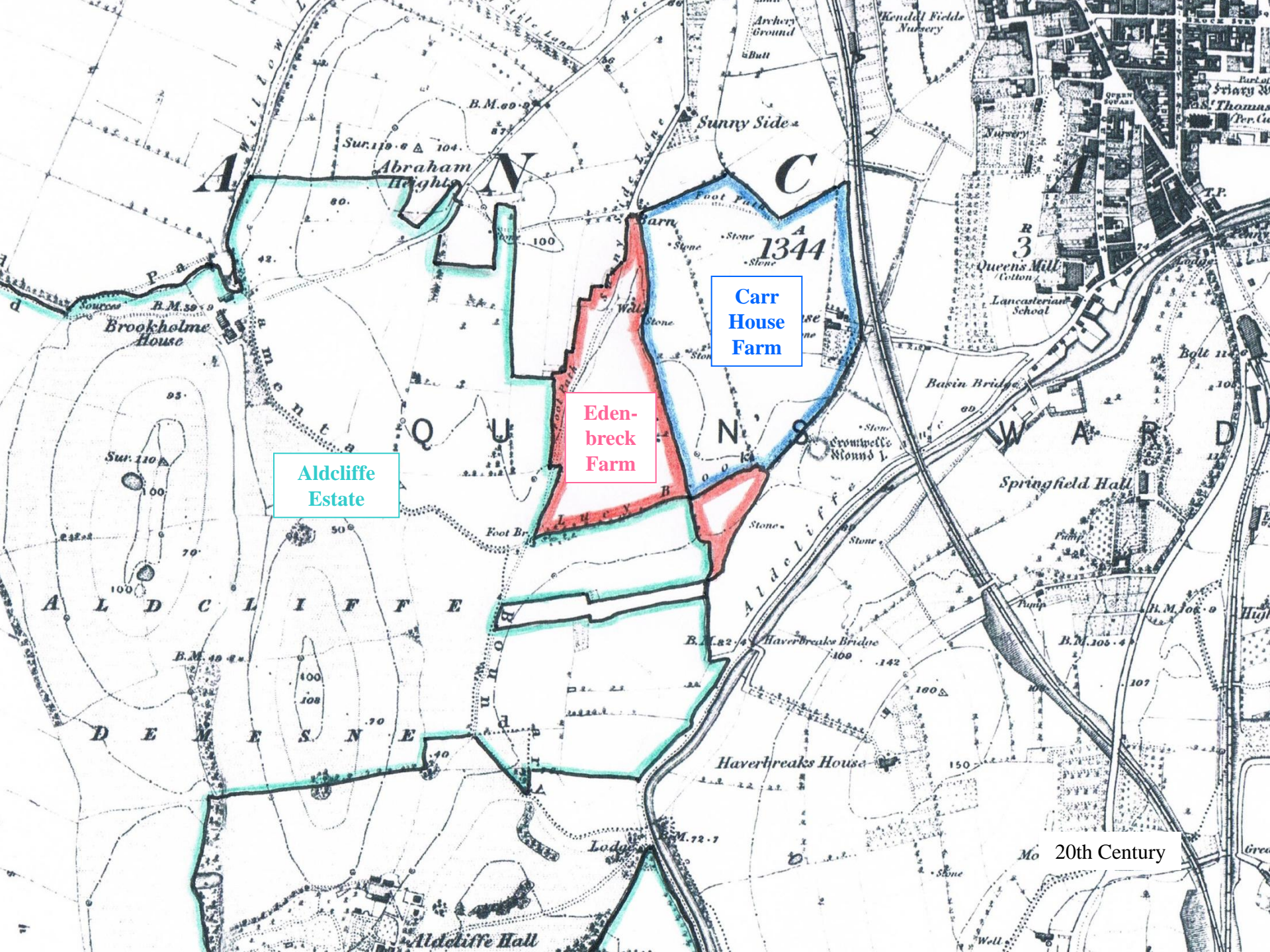

Carr House Farm

Edenbreck Farm

Aldcliffe Estate

Mo 20th Century

**Sciant ... quod ego Walterus ...
dedi ... tres acras terre mee
infra divisas de Loncastre,
scilicet ... duas acras terre in
Surholm cum omnibus
pertinenciis suis ...**

Cockersand
vol III part I p 823
c 1230





1861 census transcription details for: Green House, Lightcliffe, Hipperholme Cum Brighouse

National Archive Reference:

RG number: RG09
 Piece: 3275
 Folio: 67
 Page: 21
 Reg. District: Halifax
 Sub District: 2 Brighouse
 Parish: Hipperholme cum Brighouse
 Enum. District: 4
 Ecclesiastical District: Lightcliffe
 City/Municipal Borough:
 Address: Green House, Lightcliffe, Hipperholme Cum Brighouse
 County: Yorkshire (West riding)

Name	Relation	Condition	Sex	Age	Birth Year	Occupation , Disability	Where Born
ROBERTSON, James	Head	Married	M	29	1832	Stuff Merchant	Scotland
ROBERTSON, Jane	Wife	Married	F	25	1836		Scotland
ROBERTSON, William	Son		M	2	1859		Bradford, Yorkshire
ROBERTSON, James	Son		M	1	1860		Lightcliffe, Yorkshire
ROBERTSON, John	Brother	Unmarried	M	25	1836		Scotland
KYLES, Mary	Servant	Unmarried	F	22	1839	House Servant	Scotland

Lummore

No. of Census	ROAD, STREET, &c. and No. or NAME of HOUSE	HOUSES		NAME and Surname of Person	RELATION to Head of Family	CON- DITION as to Marriage	AGE last Birthday of	Rank, Profession, or OCCUPATION	WHERE BORN	(1) Deaf and Dumb (2) Blind (3) Insane or Idiot (4) Lunatic
		No.	Value							
	Middle Row 1/2			Mary Jane Girard	Daughter	Widow	19	Farmer's Daughter	Lancaster, Lummore	
				Ruth Do	Daughter		16	Scholar	Do Do	
				William's Pie	Grand Son		7	Scholar	Do Scotland	
41	Old Row 1/2	1		Thomas Brewer	Head	Mar	22	Farmer of 105 Acre	Do Lummore	
				Jane Do	Wife	Mar	51	Farmer's Wife	Do Latham	
				Isabella Do	Daughter	Widow	14	Farmer's Daughter	Do Lummore	
				Thomas Do	Son		10	Scholar	Do Do	
				Ellen Do	Daughter		7	Scholar	Do Do	
				Thomas Do	Grand Son		3		Do Do	
				Samuel Stephenson	Servant	Widow	22	Team Servant indoors	Do Kingsdale	
42	North Street Palace	1		Thomas Lewison	Head	Mar	41	Farmer of 84 Acre	Do Lummore	
				Isabella Do	Wife	Mar	42	Farmer's Wife	Do Kingsdale	
				Mary Do	Daughter		12	Scholar	Do Lummore	
				Francis Do	Son		10	Scholar	Do Do	
				Richard Do	Son		8	Scholar	Do Do	
				Isabella Do	Daughter		6	Scholar	Do Do	
				Deborah Do	Daughter		3		Do Do	
				Margaret L Do	Daughter		1		Do Do	
				John Plau	Servant	Widow	22	General Servant	Do Do	
				James Hodgson	Servant	Widow	22	Team Servant indoors	Yorkshire England	
				William Kellall	Uncle	Widow	20	Gentleman	Lancaster Lummore	
43	North Street	1		Joseph Smith	Head	Mar	46	Farmer of 210 Acre	Do Bolton	
				Jane Do	Wife	Mar	46	Farmer's Wife	Do Lancaster	
				Margaret A Do	Daughter	Widow	22	Farmer's Daughter	Do Latham	
				John Do	Son	Widow	20	Farmer's Son	Do Do	
Total of Houses..		5		Total of Males and Females..		11	14			

Note.—Draw the pen through each of the words of the headings as are inappropriate.



District Information

Ordered
20.1

Head entry Ref
9283905

Wood Pay ID 3132853105

Surname	Given Name	District	Volume	Page
---------	------------	----------	--------	------

Deaths Jun 1865

Robertson	William	Bradford Yk 9b		76
-----------	---------	----------------	--	----

The district **Bradford Yk** is an alternative name for **Bradford** and it spans the boundaries of the counties of **West Riding of Yorkshire** and **West Yorkshire**; information about it can be found [here](#)

Close Window

[FreeBMD Main Page](#)

Search engine, layout and database Copyright © 1998-2013 The Trustees of FreeBMD (Ben Laurie, Graham Hart, Camilla von Massenbach, David Mayall, Allan Raymond and Jim Killock), a charity registered in England and Wales, Number 1096940.

We make no warranty whatsoever as to the accuracy or completeness of the FreeBMD data. Use of the FreeBMD website is conditional upon acceptance of the [Terms and Conditions](#)



CERTIFIED COPY OF AN ENTRY OF DEATH



GIVEN AT THE GENERAL REGISTER OFFICE

Application Number 5406564-1

REGISTRATION DISTRICT	BRADFORD YORKSHIRE
1865 DEATH in the Sub-district of Horton	in the County of York

Columns:-- 1 2 3 4 5 6 7 8 9

No. When and where died Name and surname Sex Age Occupation Cause of death Signature, description and residence of informant When registered Signature of registrar

487	Fourth April 1865 11. Claremont Horton	William Robertson.	Male	6 years	Son of James Robertson, a Staff Merchant	Acute Hydrocephalus, 12 days Exhaustion Certified	William Bell In attendance 11. Claremont Horton	Fourth April 1865	W. M. Cook Registrar
-----	--	-----------------------	------	------------	---	---	--	-------------------------	-------------------------

CERTIFIED to be a true copy of an entry in the certified copy of a Register of Deaths in the District above mentioned.

Given at the GENERAL REGISTER OFFICE, under the Seal of the said Office, the 24th day of January 2014

DYD 635056

See note overleaf

CAUTION: THERE ARE OFFENCES RELATING TO FALSIFYING OR ALTERING A CERTIFICATE AND USING OR POSSESSING A FALSE CERTIFICATE ©CROWN COPYRIGHT

WARNING: A CERTIFICATE IS NOT EVIDENCE OF IDENTITY.



E. B. Dawson Esqu

LOT 2.

5

6

7

8

Sir J. K.

Trustees of Alderman Pe

Sir J. K.

Mr John

Parts of Little Edenbreck

E. B. Dawson Esquire

9

Samuel Picard Esq^r

10

LOT 3.

Samuel Picard Esq

Sourholmes

Abigail Rigbys Charity

To Lancaster

CANAL

Fences belonging to the Estate

**parcell or peice of Arable Meadow or pasture
Ground lying in a Certain Feild Inclosure or
Ground Commonly called Soweerholme ...
Adjoining to a parcell belonging to George
Townson ... on the South Side thereof and on
the North side to a parcell belonging Widdow
Heysham and Abutting upon a parcell called
Black Acre now in possession of Thomas
Stirzaker which said parcell of Land contains
by Estimation Five Roods ...**

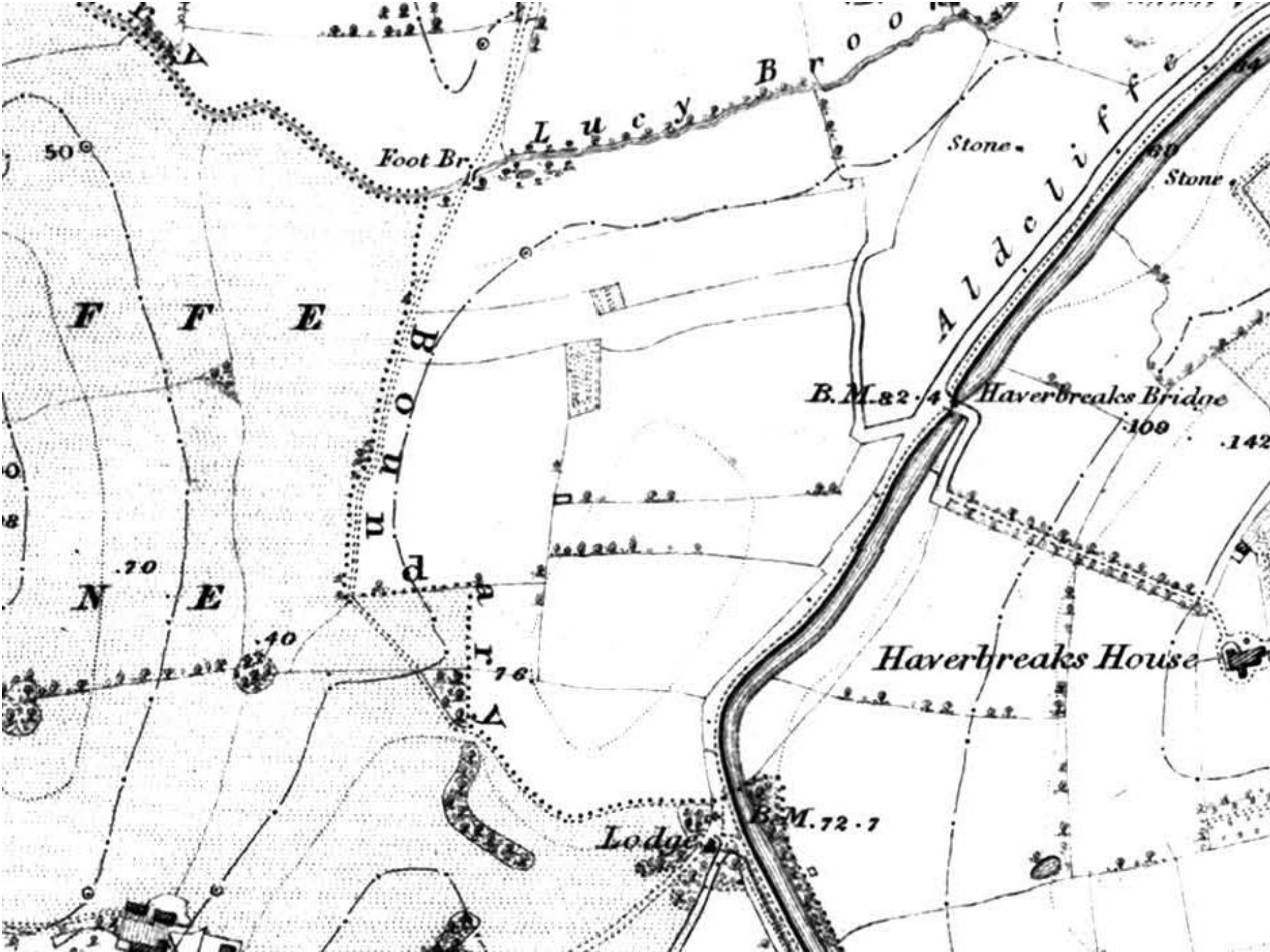

Foot Br.

Lucy Brook

Stone

Stone

B.M. 82.4 Haverbreaks Bridge

100

142

Haverbreaks House

Lodge B.M. 72.7

F F E

B O U N

N E

50

70

80

100

2 Sana pferces & pced. qd Ego Thom fil Willm de Aldeberis de Riconest Willmo de Stene & heredibz suis
suis paracult terre cu pto eoru pmerce ai pmerijs in Lancast pferces in campo qui vocat Doullham in
terra dmi Regis & terra Willm de Calbreton. tenend & hinc dnm terra ann pto ai pmerijs dno Willm
& heredibz suis de capitali dno feodi p servicia que ad dca tenentes pmerent nuptem. Et Ego Willm de
Thom & heri mo dnm terra & pto ai pmerijs. dno Willmo & heredibz suis omē omes generes servitioru
nms nuptem. In au rei testimoniu p hinc cartā sigilla meū apposui. Hinc testibz Robtu de Barton Ro
bro de Colham tuc Willm Land. Johne deu. Rob fil Simon. Willm fil anora & alijs. Dat apud Land
die Sabba in Sigilla pfecta. Anno regni Regis Edwardi fil Regis Edmudi Septimo Regis

Sciencia presentis et futuri quod Ego Thomas filius Willelmi

de Aldecleve dedi et concessi Willelmo de slene et heredibus suis

Una particula terre cum prato eidem pertinente cum pertinentiis

in Lancastre jacentes in campo qui vocatur Sourholm inter

terram Domini Regis et terram Willelmi de Baldreston.



181
182
183
192

182
181

171

164

197

120

162

163

92

179

160

154

99

100

96

194

159

104

102

95

103

101

155

156

105

91

93

94

157

92

128

107

89

90

82

147

158

88

144

108

102

87

83

81

144

115

110

104

84

85

84

80

98

95

84

80



A A A | Text only

Search



Home



Advanced Search



Showcase



Image Gallery

FAQs

Useful links

▼ Help

How do I search the database?

What are acceptable searches?

What is in the catalogue?

Glossary

Send us feedback

Advanced Search

You can search for people in specific types of archives by entering a personal name in the **Any Text Field** and selecting an option from "**Look in**"

To see if someone is on a **Preston guild roll**, enter their name in the **Any text** field and select "**Preston guild rolls**" in '**Look in**'

Any Text

▶ [Refine Search Criteria](#)

Look in...

- Apprenticeship indentures
- ▶ [Refine S](#) Bastardy records
- Coroners accounts
- Honor of Clitheroe indexes
- Marriage bonds
- Preston guild rolls
- Quarter Sessions Petitions
- ▶ [Refine S](#) Tithe apportionments
- Whittingham reception orders
- Wills and other probate documents

Date

Repository

Reference

Title

To the Right worth Justices of the peace
of the Sessions at Lancaster
The humble petition of John Barston of Quarnmo^r
Choroth

7

Mich
16 49

That your petitioner beinge a borne pore man and hath
a wife and thre small children for to maintaine
hath had greate losse by the stold armie
liuinge in the high rode at uplate called
Hofstrenyale in Quarnmo^r, and hath no thinge
losse for to maintaine them nor all yo^r pore
petitioner desire is that yo^r worthps would be
pleasod for to graunt him some reliefe towards
the bringinge up of his thre children,

May it thairfore please yo^r worthps
for to take the premises in to good
consideration and to graunt yo^r pore
petitioner an order out of this court
double for the same and yo^r pore
petitioner will ever pray for yo^r health
and hapyness

Of and betw of yo^r pore man
John Barston

JMB

Reference No.....130.....

Particulars; description, and notes made on inspection

W^m Whittaker, Rent £4 rates Farm house, King Run
 Front Rn, Parlor, Bk Kitchen, Pantry, Dairy (no cellar)
 Cheeseroom over dairy With 1/8/ per by occupier
 4 Bedrooms, 2 attics Stone built insulated 2 storey
 Shooting let to Lord Sefton £51-1 yearly, no pipe tracks
 Right to take turf off fell, loose Box, 3 stall stable, Barrier
 Pig sty, 2 Calf Halls, Luf house, Shippon for 14 loft alone
 Charges, Easements, and Restrictions affecting market value of Fee Simple
 High barn up fields tie up 8. only fair condition

Footpath 170 yd = £6
 With 1/8/ + 35 yd = £49

Valuation.—Market Value of Fee Simple in possession of whole property
 in its present condition.

		Rent	7 ²
			7.10.0
Less. Repair	7.0.0		
Income	10.0		66.10.0
			28 yd
			1862.0.0
			50.
	Shooting 5/1 + 10 yd		1912.0.0
			45
Less 50 sheep x 18/.			1867
		£	

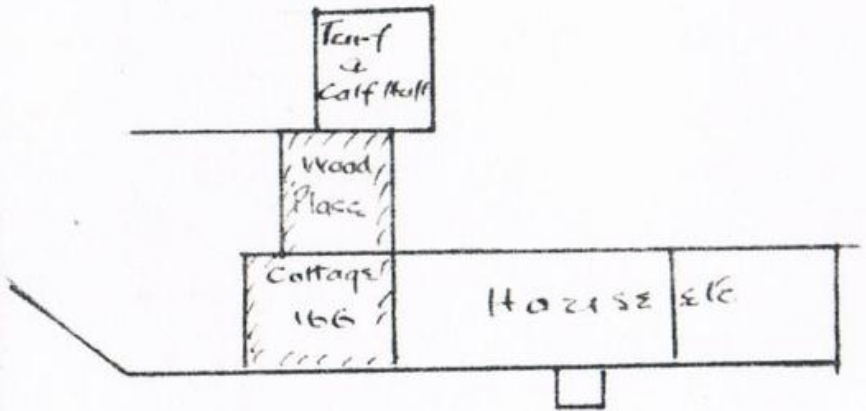

Pigs

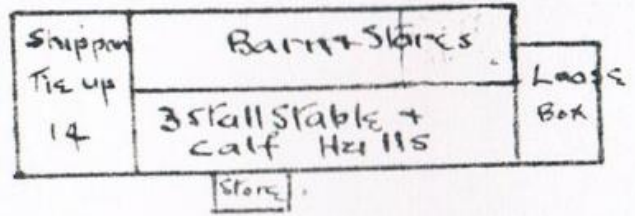

FARM SURVEY

84 (2 R.G. 44) 2/1/53

County Lancashire Code No. 1415/11
 District 2 Parish Bury
 Name of holding W. J. Barker Name of farmer W. J. Barker
 Address of farmer Bury, Lancashire
 Number and edition of 6-inch Ordnance Survey Sheet containing farmstead 35 N.W.

A. TENURE.

1. Is occupier tenant ...
 owner ...
2. If tenant, name and address of owner :—
B. J. Morris
14 Bury
Bury
3. Is farmer full time farmer ...
 part time farmer ...
 spare time farmer ...
 hobby farmer ...
 other type ...
 Other occupation, if any :—

4. Does farmer occupy other land ?

Yes	No
	<input checked="" type="checkbox"/>

Name of Holding _____ County _____ Parish _____

5. Has farmer grazing rights over land not occupied by him ? ...

If so, nature of such rights—

C. WATER AND ELECTRICITY.

Water supply :—

1. To farmhouse ...
 2. To farm buildings ...
 3. To fields ...

Pipe	Well	Roof	Stream	None
			<input checked="" type="checkbox"/>	
			<input checked="" type="checkbox"/>	
			<input checked="" type="checkbox"/>	

4. Is there a seasonal shortage of water ? ...

Yes No

Electricity supply :—

5. Public light ...
 Public power ...
 Private light ...
 Private power ...
6. Is it used for household purposes ? ...
 Is it used for farm purposes ? ...

D. MANAGEMENT.

1. Is farm classified as A, B or C ? ... B

2. Reasons for B or C :—

- old age ...
 lack of capital ...
 personal failings ...

If personal failings, details :—

combined factors

Sources for History of FAUNA & FLORA

Mike Derbyshire

